



ALTOSA
LIVORY
LIVE IVORY

2340 SQ. FT.
52 4BHK FLATS
14 FLOORS
2 TOWERS



LIVE ABOVE
THE CROWD



YOUR GATEWAY
TO A RICHER LIFE



2 Towers/52 Flats

Basement + Ground Floor + 14 Floors
[1st Floor for Amenities]

Motamava, Opp. Karnavati Party Plot,
Nr. The Windsor Gardens, Rajkot - 360 005

FLOOR PLAN

Tower A - 2nd to 14th Floors

4 BHK/2340 SQ. FT.

[Approx. Usable Carpet]

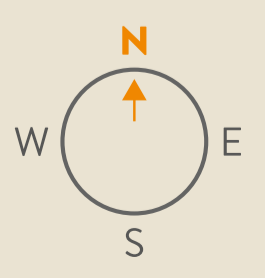
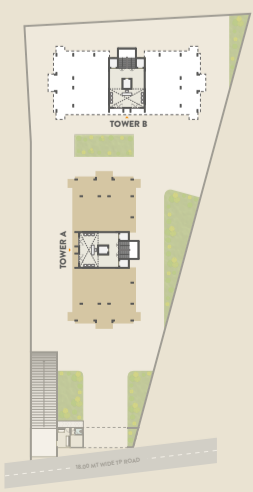

FLOOR PLAN

Tower B - 2nd to 14th Floors

4 BHK/2340 SQ. FT.

[Approx. Usable Carpet]

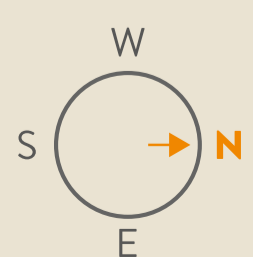
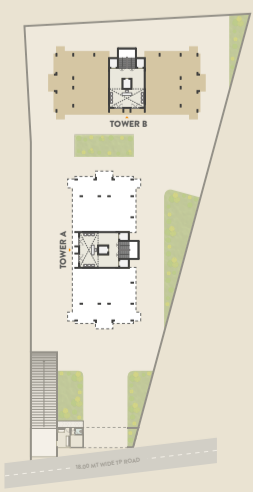

UNIT PLAN - TOWER A & B

2nd to 14th Floors

4 BHK/2340 SQ. FT.

[Approx. Usable Carpet]





ALTOSA
LIVORY
LIVE IVORY

4 BHK
LUXURIOUS FLATS
2340 SQ. FT.
[Approx. Usable Carpet]

2 Towers/52 Flats

3 ALLOTTED 
CAR PARKING 
FOR EACH FLAT 



GROUND FLOOR

Layout Plan

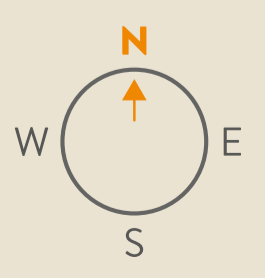
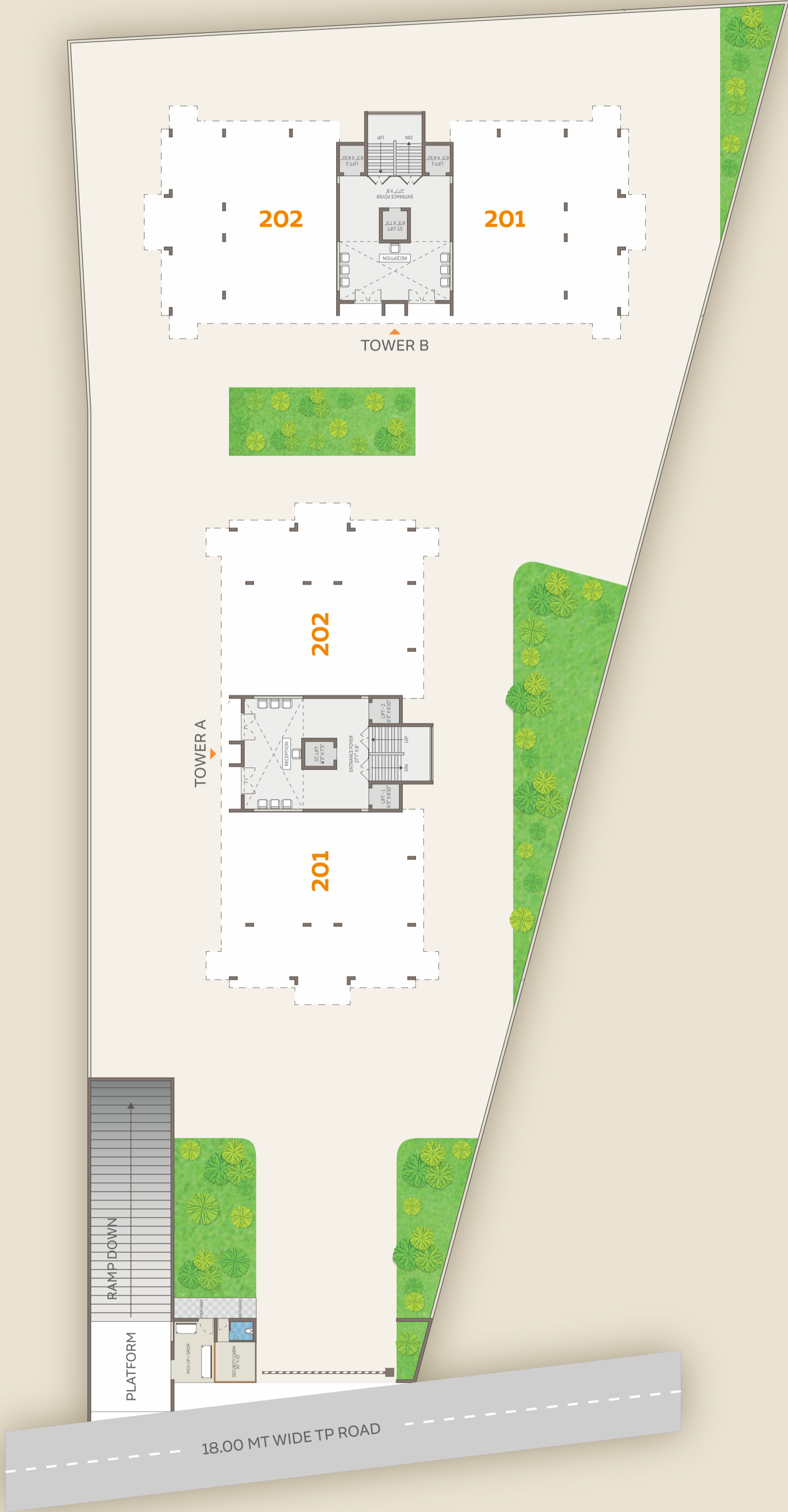

BASEMENT FLOOR

Layout Plan

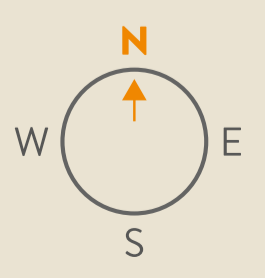
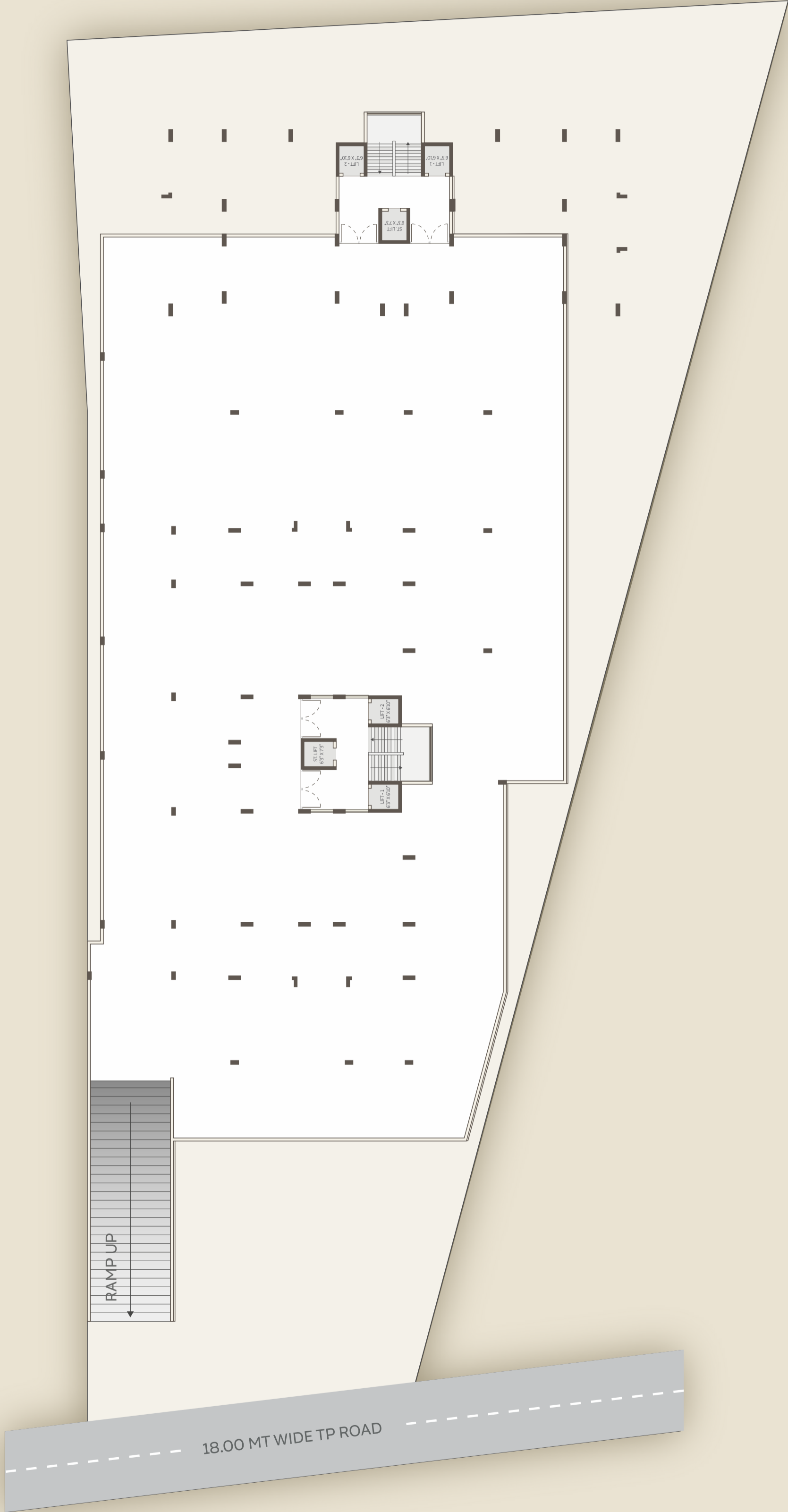

Location

Motamava

Opp. Karnavati Party Plot,
Nr. The Windsor Gardens, Rajkot - 360 005



CLUB HOUSE

Tower A - 1st Floor

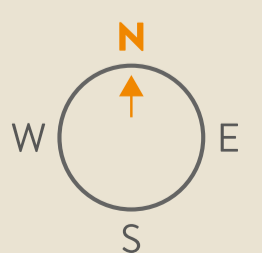
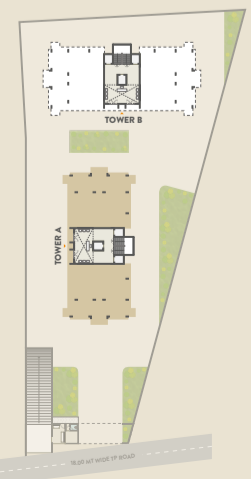

CLUB HOUSE

Tower B - 1st Floor

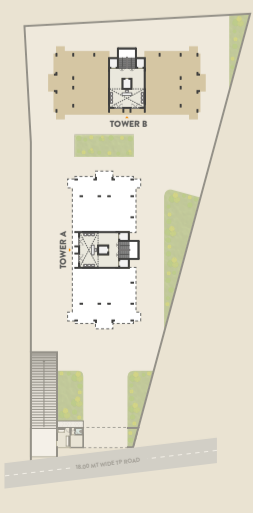
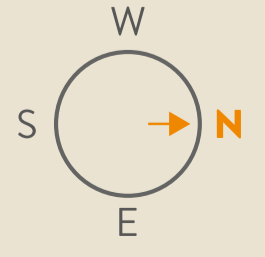

AMENITIES & FACILITIES

- INDOOR GAME ZONE
- CHILDREN ELECTRONIC GAME ZONE
- YOGA ROOM
- GYM
- THEATRE
- BANQUET HALL
- ESTATE OFFICE

- STUDENT PICK-UP POINT
- ELEGANT RECEPTION AREA
- GRAND ENTRANCE WITH BOOM BARRIER
- SECURITY CABIN
- CCTV SURVEILLANCE
- GUEST ROOM
- GREEN LANDSCAPE

- 3 ALLOTTED CAR PARKINGS FOR EACH FLAT
- FIRE SAFETY SYSTEM
- PASSENGER LIFTS
- SERVICE LIFT
- POWER BACKUP FOR COMMON AREAS
- LED LIGHTING

SPECIFICATIONS



FLOORING

Double charged vitrified tiles.



ELECTRICALS

Fire retardant copper wiring with modular switches and safety gears.



WATER METER

Provision of water meter in each flat.



PAINT

Cement putty finish on all internal walls and textured plastic with acrylic paint for external walls.



KITCHEN

White glass platform with S.S. sink, provision for chimney and RO filter.



PLUMBING

Standard CPVC & UPVC for hot & cold water supply & PVC pipe for drainage system.



SOLAR WATER HEATER

Common solar heater for each tower.



SANITARYWARE & BATH FITTINGS

Branded sanitary and bath fittings.



WASHING AREA

Separate platform with sink and provision for washing machine and geyzer.



DOOR

Laminated main door. Interior doors are not provided.



WINDOWS FEATURES

Aluminium powder coated state-of-the-art section windows with child safety grill and provision of track for insect net.



INTERCOM

Intercom facility for each flat.

Disclaimer

- Dimensions are indicative and subject to change.
- Developers reserve the rights to amend plans, specifications, elevations or any other details as may be deemed fit in the interest of the project.
- Stamp duty and registration charges would be charged extra.
- GST and any such additional taxes would be charged extra.
- Maintenance deposit would be charged extra.
- Gas, PGVCL, underground drainage, and water connection charges would be extra.
- Internal and external changes would not be permitted.
- Terrace rights would rest with the developers.
- Any additional FSI at present or in the future would be availed by the developers and no member would claim any right for the same.
- Useable carpet is for presentation only and the actual carpet area may vary.
- This brochure is for information purposes only and doesn't form a part of the agreement or any legal document.

A SYMBOL OF ELEGANCE & LUXURY



GRAND BEGINNING OF A NEW CHAPTER

The Altosa Group, led by a team of seasoned real estate professionals with years of real estate investment, development, and management experience, uncovers and delivers value beyond what might be expected from a traditional real estate company. We build value in real estate for those we serve by creating innovative, lasting environments and meaningful experiences that connect people and places.

LOCATION

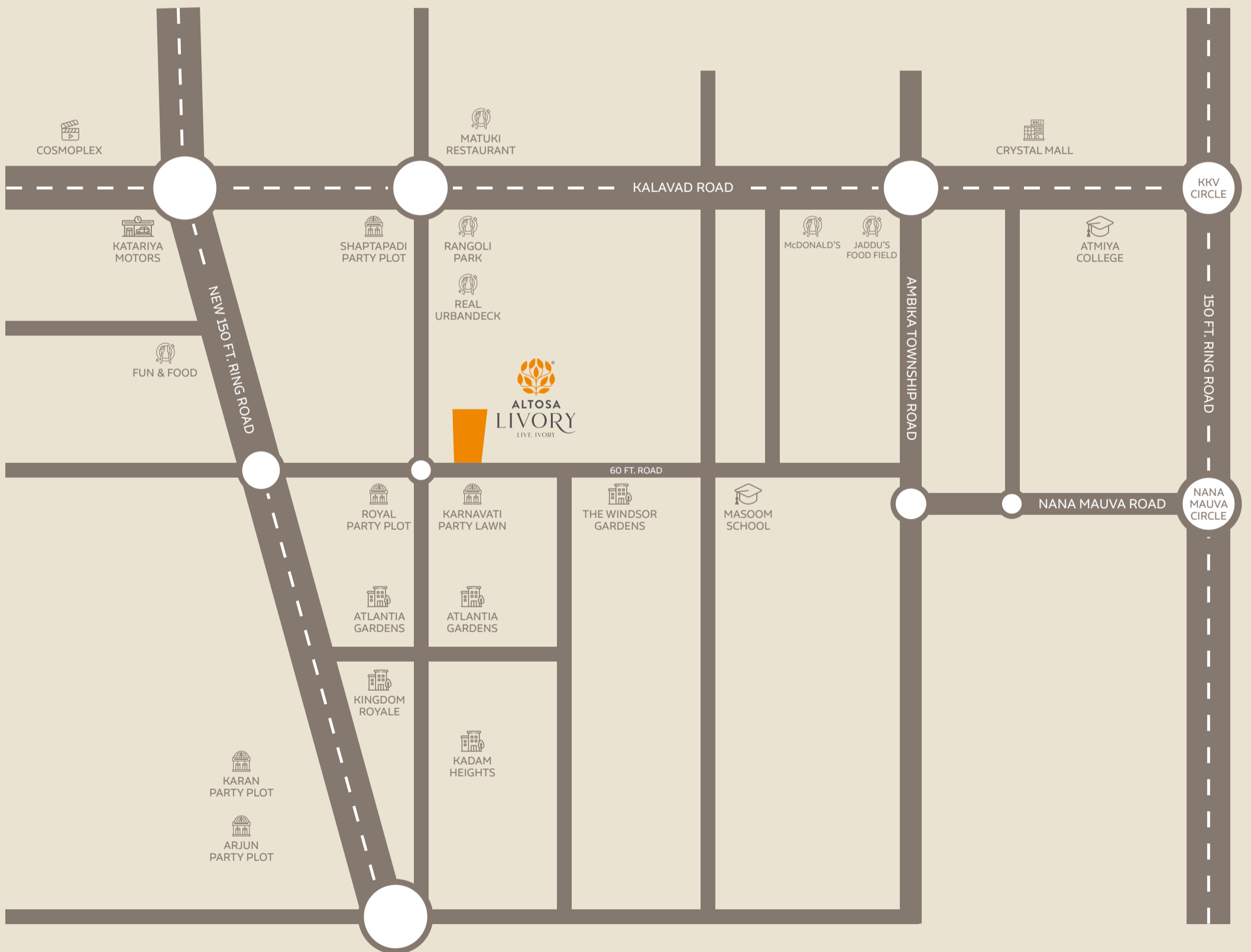

MOTAMAVA, OPP. KARNAVATI PARTY PLOT,
NR. THE WINDSOR GARDENS, RAJKOT - 360 005

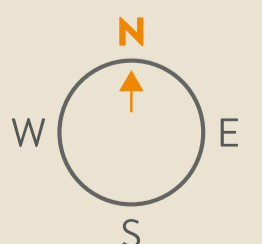



ALTOSA LIVORY

LIVE IVORY

LOCATION

MOTAMAVA, OPP. KARNAVATI PARTY PLOT,
NR. THE WINDSOR GARDENS, RAJKOT - 360 005

On-Site Team

HASMUKH UKANI NAYAN KALARIYA DIPAK VACHHANI



98 25 77 23 23



Time: 09:00 AM to 07:00 PM

VICKY ARVADIA • BHARAT DADHANIYA • SANJAY SAKARIYA
VINOD NAYAKPARA • SURESH DEKIVADIA • GIRISH KANSAGARA

- A PROJECT BY -



Visit us at

www.altosagroup.in

Connect with us

